

# HI-FINITY



  
**REYNAERS®**  
— *at home* —





## Elegance and excellence

The Hi-Finity patio door is the epitome of modern design, combining the ultimate in contemporary aesthetics with outstanding performance.

This state-of-the-art structurally glazed door offers the possibility of floor-to-ceiling and wall-to-wall glass, an ergonomically designed handle and a concealed locking system.

For the discerning householder or architect who wants the very latest in contemporary design and ultimate performance, the Hi-Finity door sets a new benchmark of excellence.





## Big and beautiful

With a towering maximum door height of three and a half metres and a maximum door panel weight of as much as 500kg<sup>(6)</sup>, the Hi-Finity door stretches the boundaries of what is possible in terms of size.





## Designed not to be seen

Beautiful as it is, the Hi-Finity door is designed to be looked through, not to be looked at.

The outer frame can be built into the structure of the building, making the dream of floor-to-ceiling and wall-to-wall glass a reality.

The interlock between door panels is incredibly narrow, measuring only 35mm wide, and the frame and spacer bars between the panes of glass are both black, helping the door to frame your view in a most unobtrusive way.

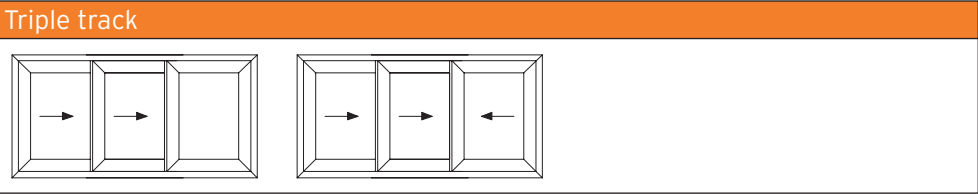
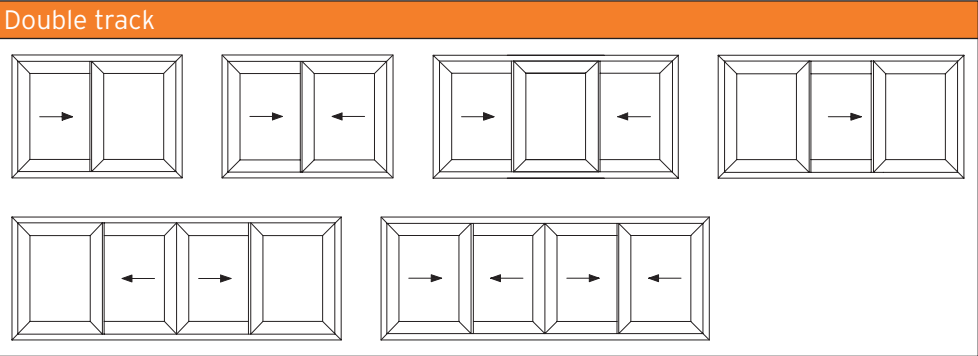

Technical Characteristics			
Variants		DOUBLE GLAZING	TRIPLE GLAZING
Height	Built-in frame	68 mm / 100 mm	
Visible width/height	Vents	8 mm / 10mm	
	Meeting section	35 mm	
	Meeting section 4 doors	67 mm / 69mm	
Overall system depth	Frame	2-Track : 147 mm 3-Track : 234 mm	2-Track : 179 mm 3-Track : 282 mm
	Vent	44 mm	60 mm
Maximum element height		3500 mm	
Maximum vent weight		500 kg / 300 kg motorised	
Glass thickness		36-38 mm	52-54 mm
Glazing method		Structural glazing	
Thermal insulation		41 and 50 mm fibreglass reinforced polymide strips	

Designed to be versatile

By combining these huge door panels in a range of double track and triple track designs, Reynaers at Home can offer a truly panoramic expanse of glass to make the most of any view. It is even possible to combine two Hi-Finity doors on adjoining walls using one of a range of innovative corner solutions.

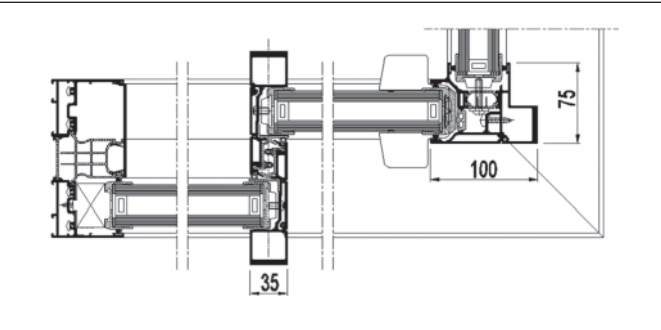

Opening corner solution

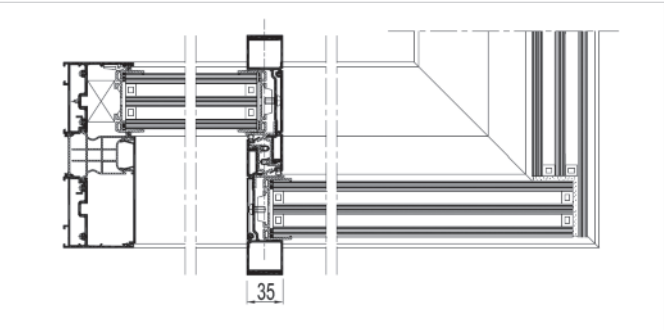

Fixed corner solution

Technically advanced

This versatile sliding door system can be specified to meet the needs of a specific project:

- Choice of frame profiles
- Choice of double or triple glazing
- Solutions for installation with or without a gutter
- Industry-leading maximum height at 3.5m

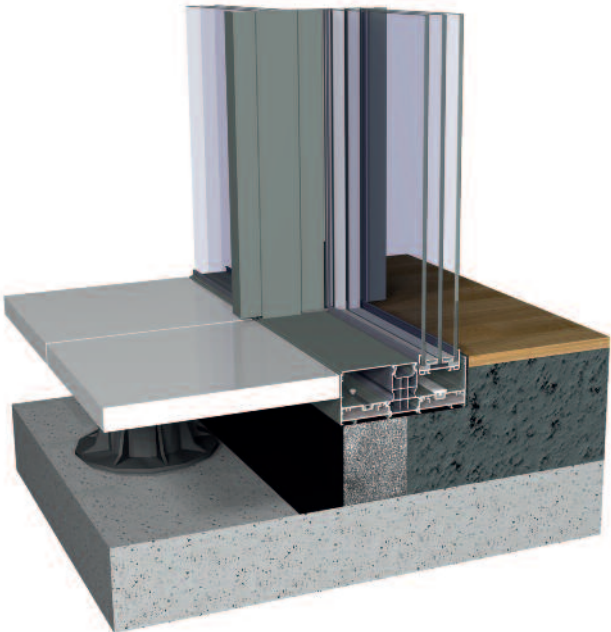

With gutter

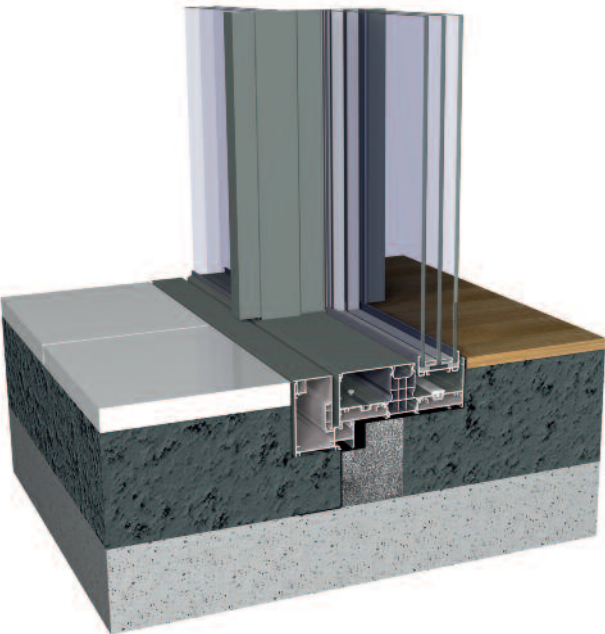

Without gutter





Concealed locking mechanism makes it very difficult for would-be intruders to tamper with the lock



Concealed motor for the ultimate convenience

## Automatic operation

All Hi-Finity doors incorporate an electronic locking system<sup>(8)</sup> that is concealed in the top frame profile and is operated via either a wall-mounted push button or a remote control.





For the ultimate in convenience and to create a stunning feature in any room, the Hi-Finity door can be specified with an integrated motor that is concealed in the top frame profile. At the push of a button the door opens smoothly, and when closed the locks will automatically engage.

## Performance

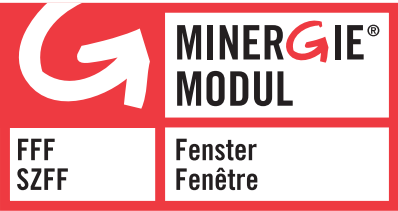
Of course the Hi-Finity sliding door also offers exceptional levels of thermal insulation, weather resistance and security.

- Choice of double or triple glazing
- Ud values as low as 1.0W/m²K (for a door that is 4.5x2.3m with Ug 0.7 W/m²K and Psi of 0.07)
- Has been awarded the coveted Swiss Minergie accreditation for thermal efficiency
- Complies with European security standard RC2
- Air tightness up to class 4 (600Pa)
- Water tightness up to class 9a (600 Pa)<sup>(7)</sup>



Performances																
	Energy															
	Thermal Insulation <sup>(1)</sup> EN ISO 10077-2					Ud value down to 1.0 W/m²K, depending on the frame/vent combination with triple glazing.										
	Comfort															
	Air tightness, max. test pressure <sup>(2)</sup> EN 1026; EN 12207					1 (150 Pa)		2 (300 Pa)		3 (600 Pa)		4 (600 Pa)				
	Water tightness <sup>(3)</sup> EN 1027; EN 12208					1A (0 Pa)	2A (50 Pa)	3A (100 Pa)	4A (150 Pa)	5A (200 Pa)	6A (250 Pa)	7A (300 Pa)	8A (450 Pa)	9A (600 Pa)	E900 (900 Pa)	
	Wind load resistance, max. test pressure <sup>(4)</sup> EN 12211; EN 12210					1 (400 Pa)		2 (800 Pa)		3 (1200 Pa)		4 (1600 Pa)		5 (2000 Pa)		Exxx (>2000 Pa)
	Wind load resistance to frontal deflection EN 12211; EN 12210					A (≤1/150 Pa)			B (≤1/200 Pa)			C (≤1/300 Pa)				
	Safety															
	Burglar resistance <sup>(5)</sup> EN 1628-EN 1630; EN 1627					RC 1			RC 2			RC 3				

This table shows classes and values of performances, which can be achieved for specific configurations and opening types.

(1) The Ud-value measures the heat flow. The lower the Ud value, the better the thermal insulation of the door.  
(2) The air tightness test measures the volume of air that would pass through a closed door at a certain air pressure.  
(3) The water tightness test involves applying a uniform water spray at increasing air pressure until water penetrates the door.  
(4) The wind load resistance is a measure of the profile's structural strength and is tested by applying increasing levels of air pressure to simulate the wind force.  
(5) The burglar resistance is tested by static and dynamic loads, as well as by simulated attempts to break in using specified tools.  
(6) Refer to Reynaers' technical catalogue for maximum sizes and operational force requirements.  
(7) Achieved using the 100mm frame at the sill.  
(8) Connection to the household electricity circuit necessary. Please refer to Reynaers' technical department for the voltage requirements.



Exclusive wheel carriages combine engineering excellence and the very best materials

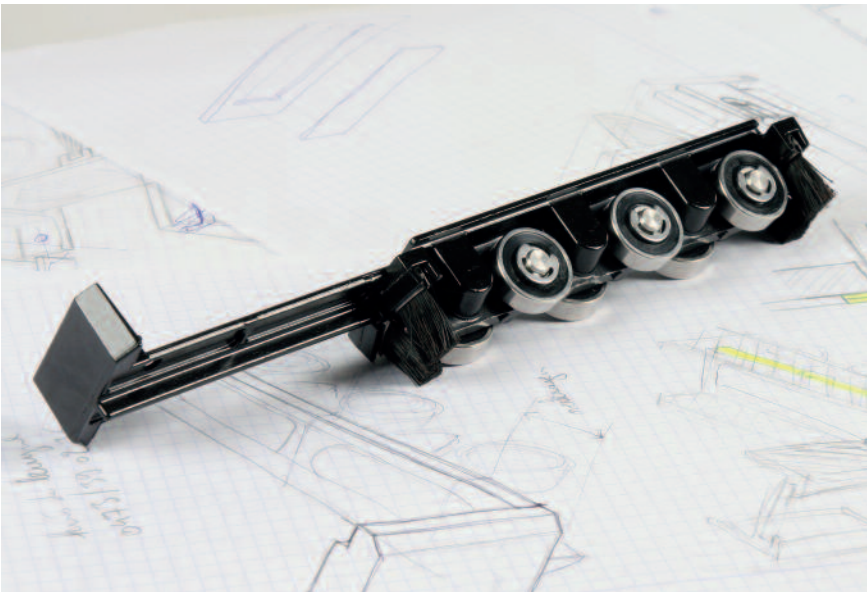

## Better by design

The Hi-Finity door is manufactured to very precise dimensions, however the apertures into which the doors are installed are not always quite so precise. Some very clever, patented design makes it possible to adjust both the locking plate and the alignment of the door panels on site, ensuring that your Hi-Finity door can be installed perfectly and will offer many years of reliable service.



Locking plate adjustment

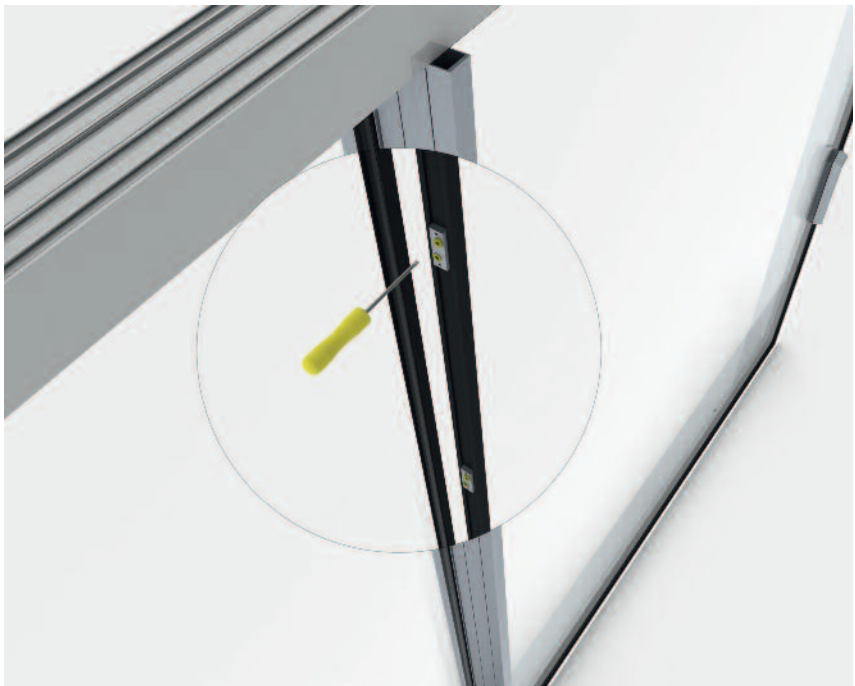

Door panel adjustment

## Expert engineering

The design that makes it possible to move half a ton of glass smoothly, easily and safely is tribute to an exceptional level of engineering expertise. This elegant sliding door exemplifies attention to detail and some very clever design. The compact wheel carriages (patent pending), for example, are made using only the highest quality materials; the six stainless steel wheels being set at an angle to operate smoothly with even the heaviest loads.





# Attention to detail

The handle for the Hi-Finity sliding door is nothing less than a beautifully crafted masterpiece. Its slim design perfectly complements the contemporary styling of the door, and the soft touch materials and ergonomic design will bring a smile to your face every time you use it.



# Credentials and accreditations

Reynaers at Home is proud to be part of a well established and professional global organisation. Our product range has been independently tested to meet and often exceed the requirements for a range of British and European standards. What is more, Reynaers is proud to have been awarded a number of more general accreditations, including ISO 9001:2000, ISO 14001, ISO 16001 and ISO 50001.



# Customer service

Reynaers at Home products are available through a small network of carefully selected expert dealerships. All have demonstrated an exceptionally high level of customer service and have agreed to work to our stringent code of conduct.



At Reynaers we constantly seek to develop and improve our products and service for our customers and therefore reserve the right to amend our product specification from time to time. The photographs in this brochure show Reynaers products which may occasionally differ in detail and appearance from those we currently sell.





Reynaers at Home · Kettles Wood Drive · Birmingham · B32 3DB

**T** 0121 421 9707 **E** [homeuk@reynaers.com](mailto:homeuk@reynaers.com)

[www.reynaersathome.co.uk](http://www.reynaersathome.co.uk)

Part of the Reynaers family

